



# American Pneumatic Tool

9949 Tabor Place, Santa Fe Springs, California, CA 90670, U.S.A.

## MODEL 118 CLAY DIGGER

PART # 5201 (7/8" HEX x 3-1/4")  
PART # 5202 (1" HEX x 4-1/4")



The APT Model 118 Clay Digger is used for digging clay, shale, hard pan and frozen ground. The Model 118 is an ideal tool for clearing out dirt under existing foundations and for tunneling under existing structures. This medium weight tool can be used for horizontal work and for vertical work. The only difference between the M117, M118 and M119 tools are the handles. These tools have the same cylinders and the majority of the internal parts in common, which makes them very versatile tools for use in various types of work. The M118 features APT's patented Ball Valve design. (Pat. # 8,276,682 B2)

### SPECIFICATIONS

Part #	5201	5202
Chuck Size	7/8" Hex x 3-1/4"	1" Hex x 4-1/4"
Bore Diameter (inches)	1-3/4"	
Stroke (inches)	3-3/8"	
Blows per Minute	1850	
CFM @ 90 psi	34 - 36	
Weight (lbs)	31	
Length (inches)	22 1/2"	
Air Inlet Size	3/8" MALE NPT	

### FEATURES

- New! Automatic Ball Valve
- Built-in automatic oiler
- Drop forged, steel, D-style handle
- Replaceable chuck bushing
- Latch type retainer
- Deep, case hardened forged alloy steel cylinder

For assistance in any sales, technical, maintenance or repair questions, please call APT @  
Phone: (800) 532-7402 or (562) 204-1555 • Fax: (800) 715-6502 or (562) 204-1773

Website: [www.apptools.com](http://www.apptools.com) • e-mail: [info@apptools.com](mailto:info@apptools.com)

TDS-1049 Rev B



# American Pneumatic Tool

9949 Tabor Place, Santa Fe Springs, California, CA 90670, U.S.A.

## APT MODEL 118 CLAY DIGGER

PART # 5201 (7/8" HEX x 3-1/4")  
PART # 5202 (1" HEX x 4-1/4")

STANDARD VALVE TYPE

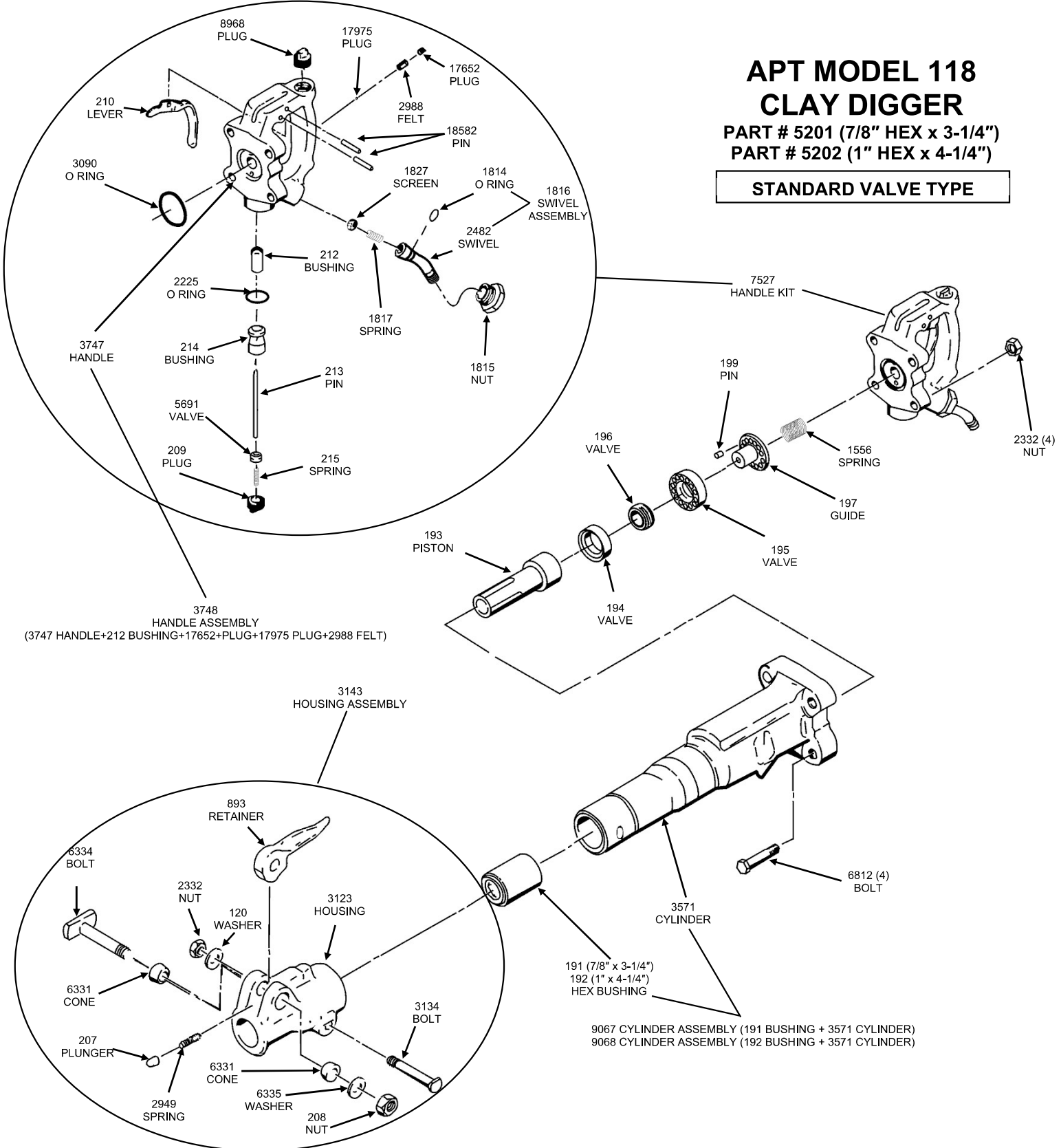

For assistance in any sales, technical, maintenance or repair questions, please call APT @  
Phone: (800) 532-7402 or (562) 204-1555 • Fax: (800) 715-6502 or (562) 204-1773

Website: [www.apr-tools.com](http://www.apr-tools.com) • e-mail: [info@apr-tools.com](mailto:info@apr-tools.com)

TDS-1050 Rev A

©2011 AMERICAN PNEUMATIC TOOLS, INC.



# American Pneumatic Tool

9949 Tabor Place, Santa Fe Springs, California, CA 90670, U.S.A.

## APT MODEL 118 CLAY DIGGER

PART # 5201 (7/8" HEX x 3-1/4")  
PART # 5202 (1" HEX x 4-1/4")

**BALL VALVE TYPE**  
Patent # 8,276,682 B2

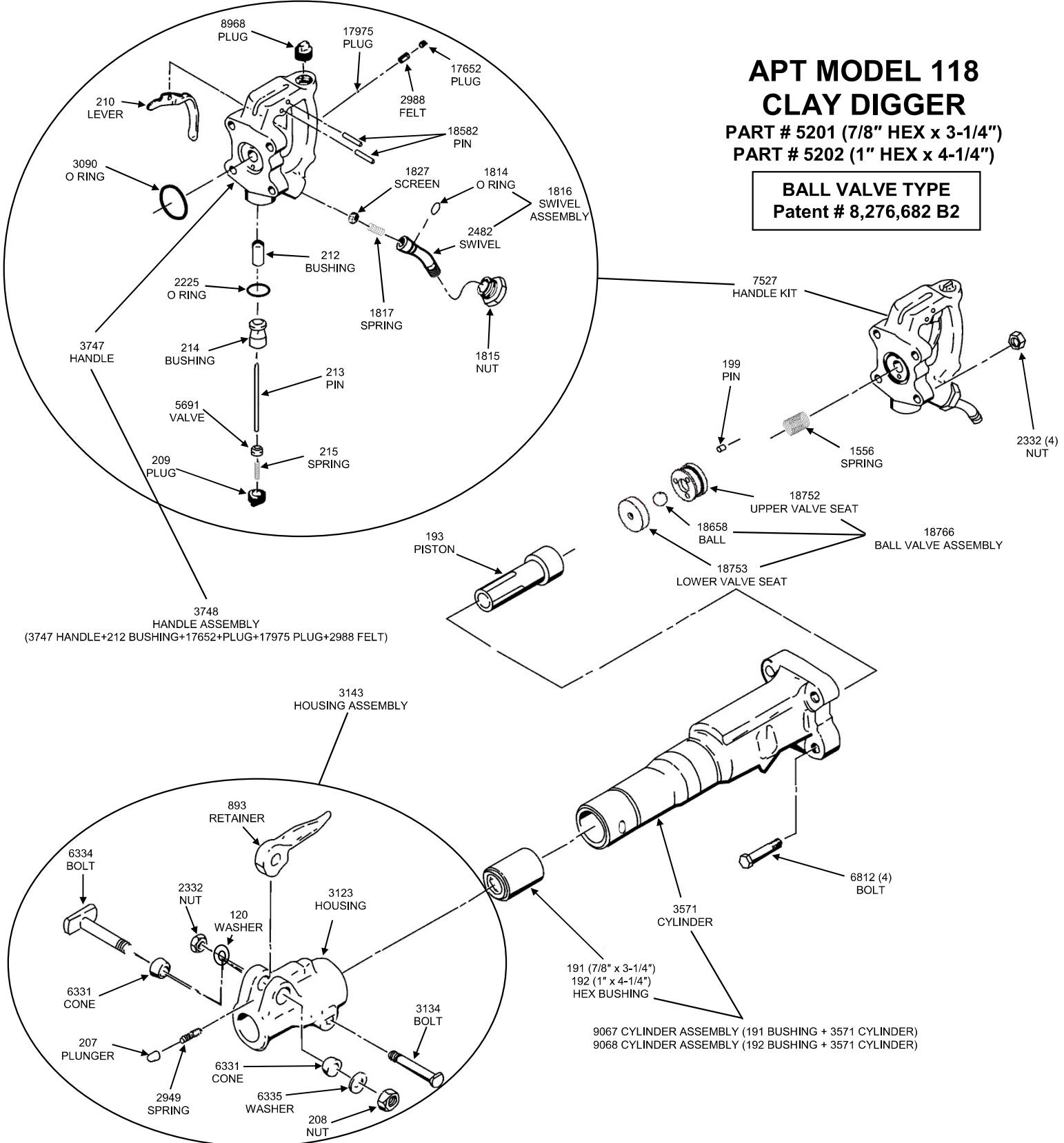

For assistance in any sales, technical, maintenance or repair questions, please call APT @  
Phone: (800) 532-7402 or (562) 204-1555 • Fax: (800) 715-6502 or (562) 204-1773

Website: [www.apr-tools.com](http://www.apr-tools.com) • e-mail: [info@apr-tools.com](mailto:info@apr-tools.com)

TDS-1107 Rev B